



Cold-Cathode Voltage-Stabiliser

Code: G75/3G (CV4030)

The G75/3G is a gas-filled voltage-stabiliser which has been developed for applications where conditions of vibration and mechanical shock are encountered. The valve has two anodes which may be used strapped together or with one as a priming anode.

MECHANICAL DATA

Maximum overall length (less leads)	80.2	mm
Maximum seated height	66.7	mm
Maximum diameter	30.2	mm
Minimum lead length	50.8	mm
Base	Flying lead octal	
Net weight	32	g
Mounting position	Unrestricted	

CHARACTERISTICS

Maximum priming anode striking voltage	115	V	
Maximum transfer voltage	$\left\{ \begin{array}{l} \text{priming anode supply} \\ \text{voltage 115 V through} \\ \text{100 k}\Omega \text{ resistor} \end{array} \right\}$	90	V
Stabilising voltage at 30 mA		75	V \leftarrow
D.C. operating current	5 to 60	mA	
Nominal regulation, 5 to 30 mA	2.5	V \leftarrow	
Maximum regulation, 5 to 30 mA	3.5	V \leftarrow	
Nominal regulation, 5 to 60 mA	5.25	V \leftarrow	
Maximum regulation, 5 to 60 mA	6.5	V \leftarrow	
Nominal drift in stabilising voltage (0 to 1000 hours)	1	V \leftarrow	
Temperature coefficient, -20 to $+90^{\circ}\text{C}$	+5	mV/ $^{\circ}\text{C}\leftarrow$	
Ambient temperature range	-55 to $+90$	$^{\circ}\text{C}\leftarrow$	

NOTE.—Sufficient resistance must always be used in series with this type to limit the current through the valve to 60 mA. Not less than the maximum striking voltage should be provided to ensure starting during life.

Operation with reversed polarity will damage this valve.

Cold-Cathode Voltage-Stabiliser



Code: G75/3G (CV4030)

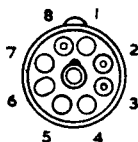
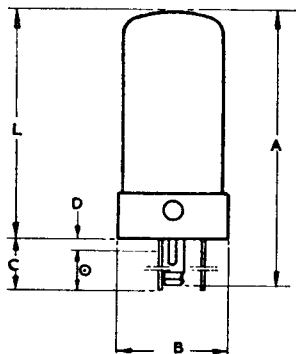

- BASING.
1. NO LEAD
 2. ANODE
 3. PRIMING ANODE
 4. NO LEAD
 5. NO LEAD
 6. NO LEAD
 7. NO LEAD
 8. CATHODE

DIM.	MILLIMETRES	INCHES
A	80.2 MAX.	$3\frac{1}{2}$ MAX.
B	30.2 MAX.	$1\frac{1}{8}$ MAX.
C	50.8 MIN.	2 MIN.
D	3.2 NOM.	$\frac{1}{8}$ NOM.
L	66.7 MAX.	$2\frac{3}{4}$ MAX.

NOTE: BASIC FIGURES ARE INCHES

⊙ DENOTES: LEADS TINNED OVER THIS PORTION